

# Quick Start Guide

## CREATOR PRO

SZ10-EN-A02

### WARNING

1. Do not remove the wrapping around the nozzle.
2. Hot! Avoid touching the heating nozzle in operation.
3. Moving parts in printer may cause injury. Do not wear gloves or other sources of entanglement in operation.

### USER GUIDE

The User Guide is in the SD card.

## Kit Contents

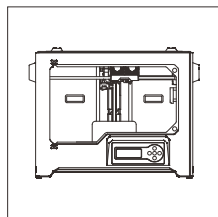

3D Printer

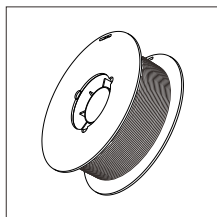

Filament Spool x 2

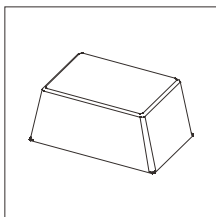

Lid



After-sales Service Card

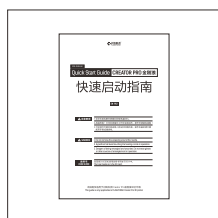

Quick Start Guide

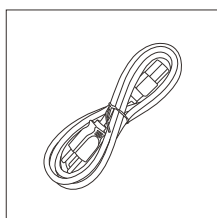

Power Cable

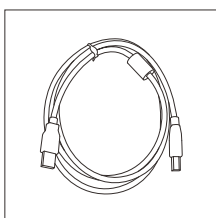

USB Cable

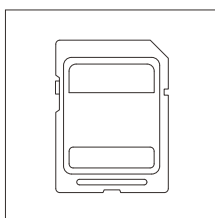

SD Card

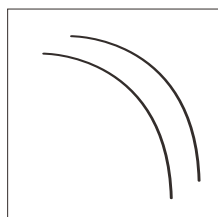

Filament Guide Tube x 2

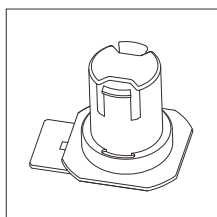

Spool Holder x 2



Build Tape x 2



Leveling Card



Tool Bag



Extruder's  
Accessory Kit

### Tool bag:

(Allen Wrench X 2 / Leveling knob X 1 /  
M3X8 Bolt X 2 / PTFE Tube X 2 / Grease X 1)

### Extruder's accessory kit:

(M3X8 Bolt X 2 / M3X6 Bolt / Turbofan baffle)

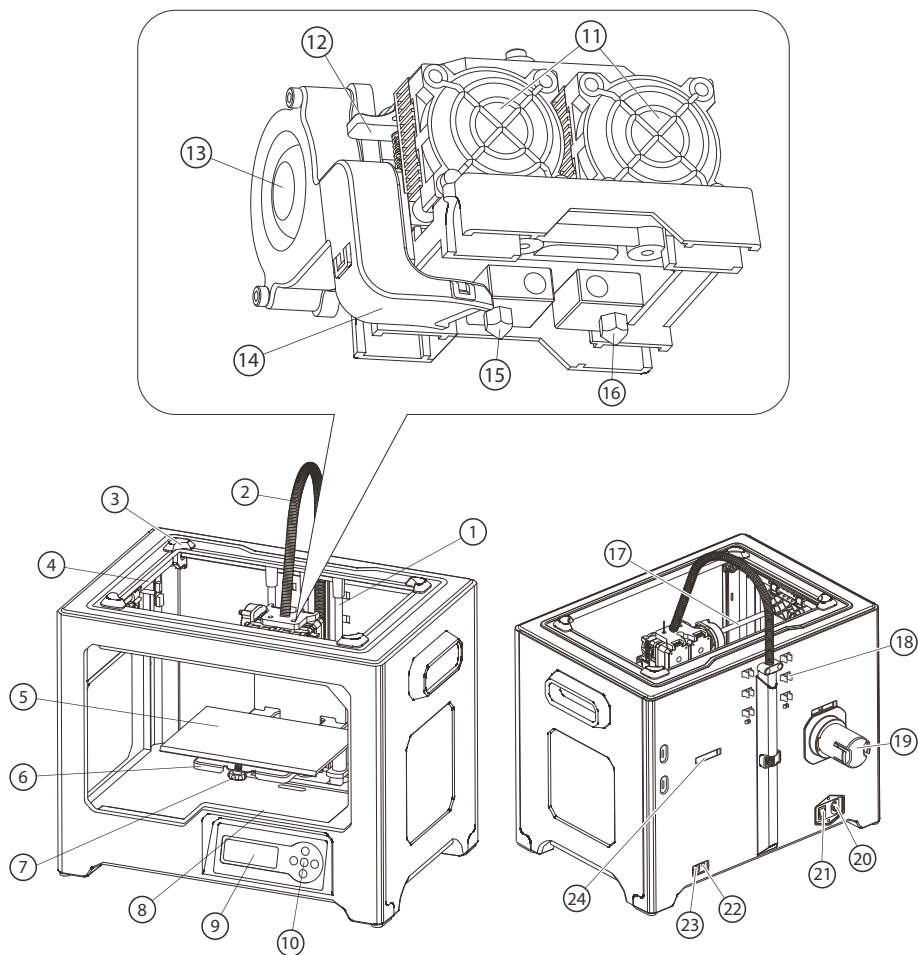

- |                       |                                |                  |                     |
|-----------------------|--------------------------------|------------------|---------------------|
| 1. Z-Axis Guide Rod   | 2. Extruder Cable Bunch        | 3. Slot          | 4. Y-Axis Guide Rod |
| 5. Build Plate        | 6. Build Platform              | 7. Leveling Knob | 8. SD Card Slot     |
| 9. LCD Panel          | 10. Buttons                    | 11. Cooling Fan  | 12. Spring Presser  |
| 13. Turbofan          | 14. Turbofan Baffle            | 15. Left Nozzle  | 16. Right Nozzle    |
| 17. X-Axis Guide Rod  | 18. Filament Guide Tube Buckle | 19. Spool Holder |                     |
| 20. Power Input       | 21. Power Switch               | 22. Reset Button | 23. USB Input       |
| 24. Spool Holder Slot |                                |                  |                     |

## Unpacking



1. Open box and remove top foam piece.



2. The foam should contain: two filament guide tubes, two piece of build tape, one Flashforge leveling card and one Quick Start Guide.



3. Firmly grasp the two side handles of Flashforge Creator Pro. Lift it out from the carton and place it on a stable surface.



4. Remove the packing bag. And then remove the tape and plastic wrap for protecting the front door.

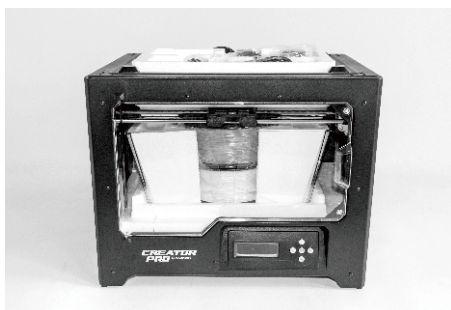

5. The Flashforge Creator Pro and its accessories shall be displayed in front of you.



6. Take the dual extruder out and place the extruder carefully because the extruder cable bunch is short.



7. Remove the foam container. It should contain: power cable, USB cable, two spool holders, SD card, tool bag, extruder's accessory kit.



8. Slide the X-axis Rods to the very back.



9. Remove lid, which should hold two rolls of filament.

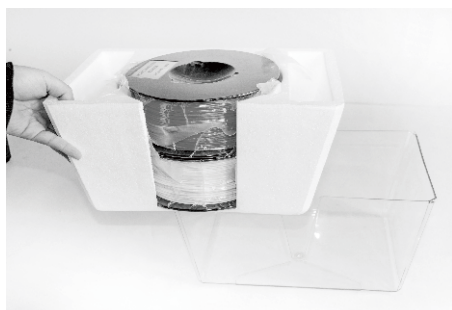

10. Take the two rolls of filament out from the lid.

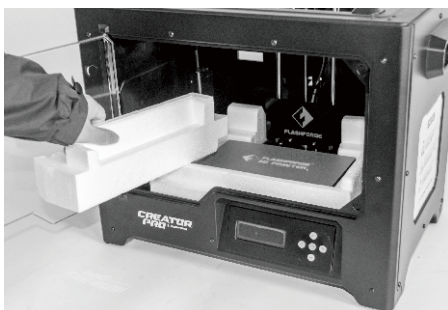

11. Remove side protective foam sheets from inside the printer.



12. Elevate the build plate to its limit with care.

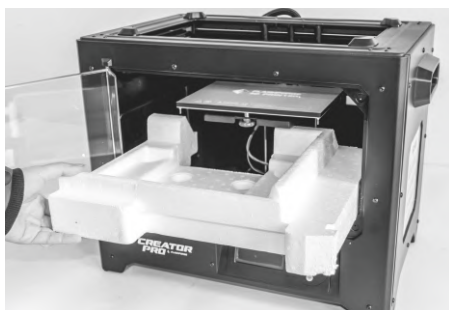

13. Take the bottom protective foam from the printer and then lower the build plate back.



14. Congratulations! You've finished the unpacking process. (Tip: Save your Flashforge Creator Pro packaging for future transportation and storage.)

## Installation and Dismantlement

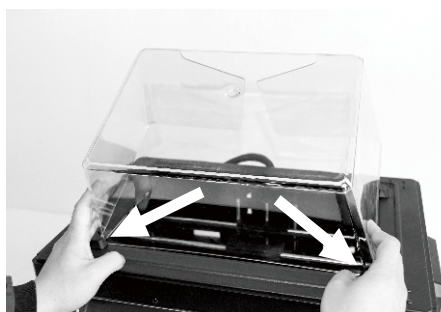
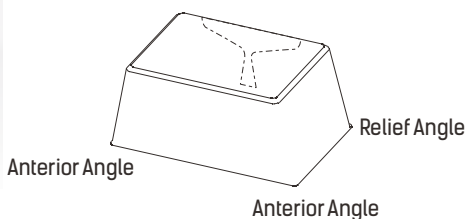

1. Place the two anterior angles of the lid into the corresponding front slots.

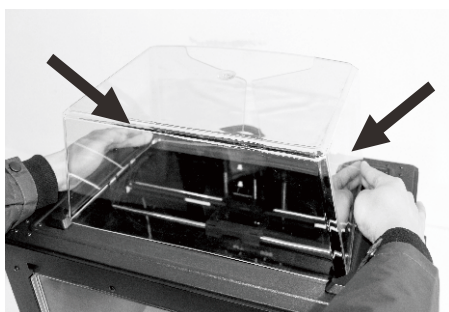

2. Slightly squeeze the two relief angles to place them into the corresponding rear slots. To remove the lid, squeeze the relief angles to remove them from the slots.

### Extruder Assembly

1. Place the dual extruder on the extruder seat.
2. Take the M2.5 Allen Wrench from the tool bag and two M3 x 8 bolts(longer ones) from the extruder's accessory kit.
3. Adjust the extruder location to align the bolt holes.
4. Secure the extruder onto the extruder seat by screwing the M3 x 8 bolts in.

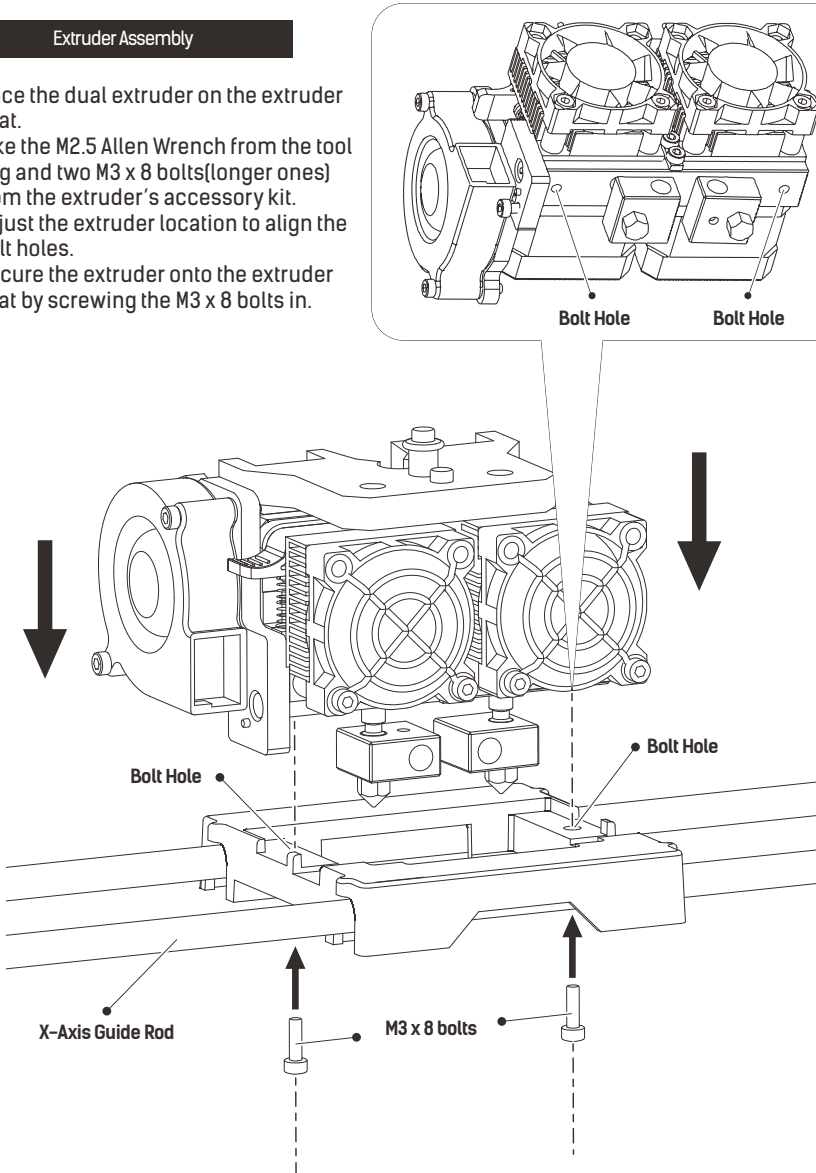

## Turbofan Baffle Assembly

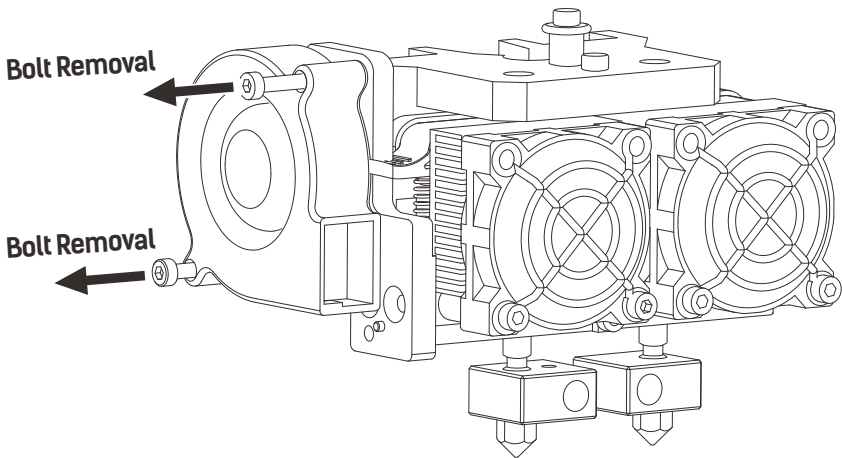

1. Use the M2.5 Allen Wrench to remove two turbofan bolts.

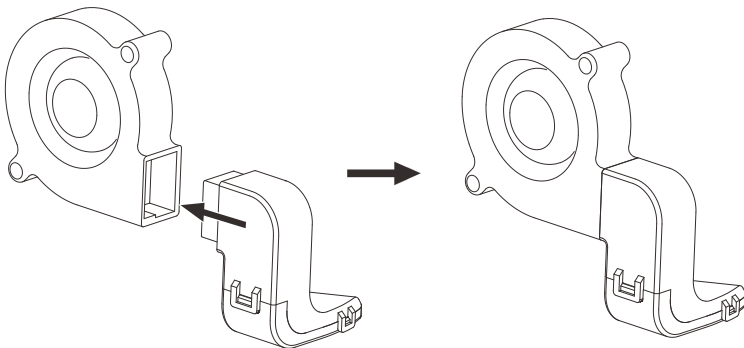

2. Take the turbofan baffle from the extruder's accessory kit.
3. Install the turbofan baffle to the turbofan.



Turbofan Seat

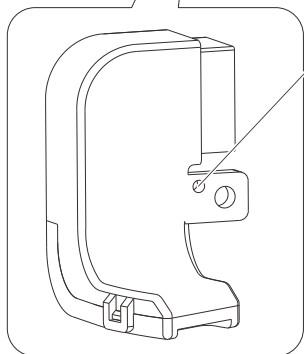
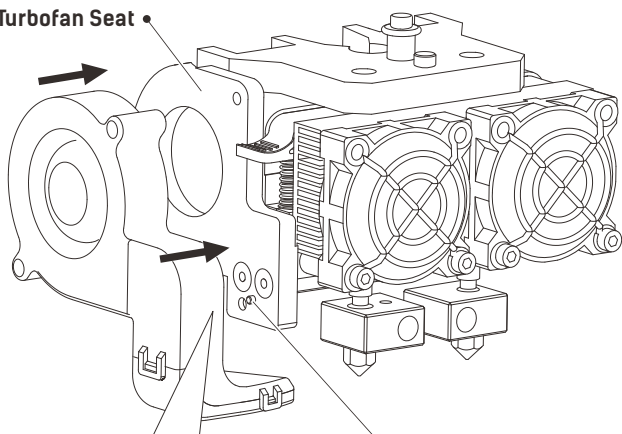

● **Align the bump on the turbofan seat to the hole in turbofan sub-assembly.**

1. Place the turbofan sub-assembly besides the turbofan seat.
2. Insert the bump on the turbofan seat to the turbofan sub-assembly.
3. Screw the two bolts in.
4. Take a M3 x 6 bolt from the extruder's accessory kit and complete installation according to the instruction below.

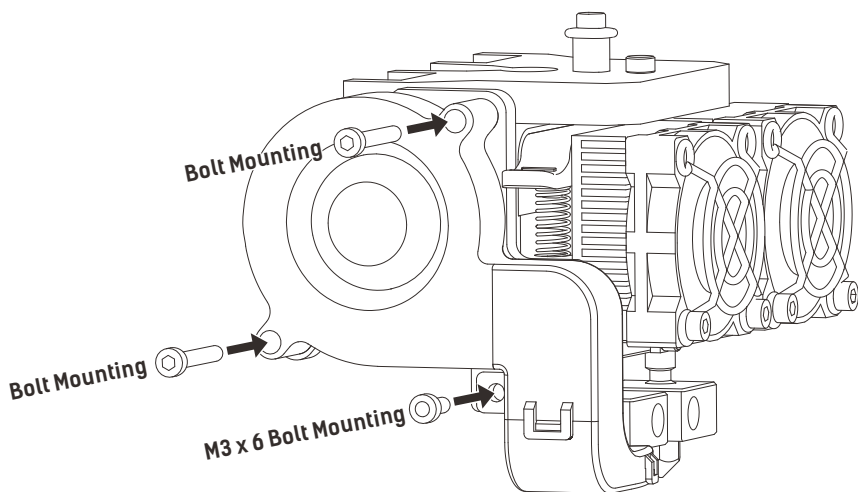

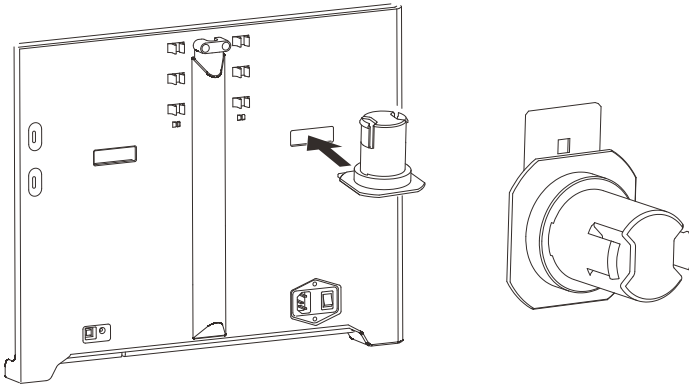

1. To install a spool holder, level it and insert the end into the corresponding opening.

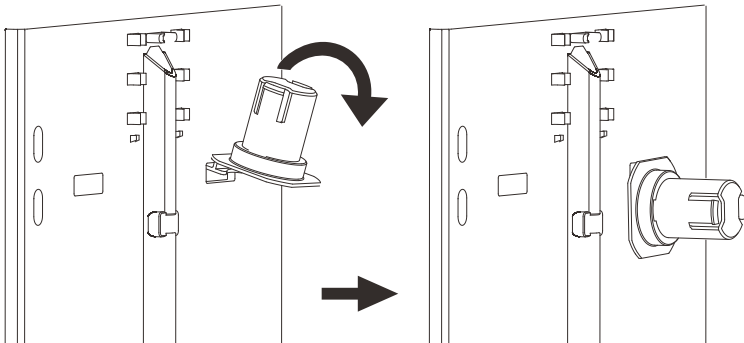

2. Turn down the spool holder to make the holder bottom cleave to the printer back.

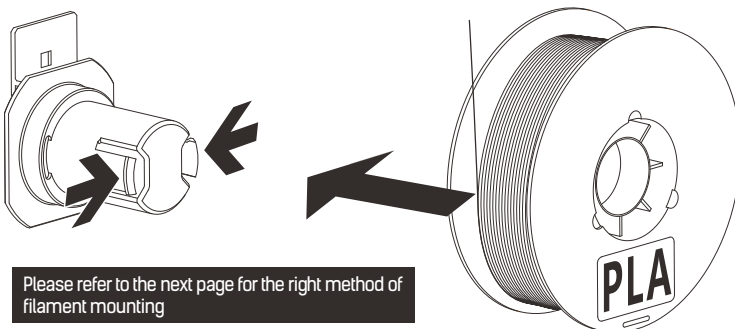

Please refer to the next page for the right method of filament mounting

3. Take a roll of PLA filament, then squeeze the spool holder top and mount the filament spool to the holder.

## Tips

- The filament spool must be oriented correctly (see below).
- The filament guide tube ensures stable printing and protects the printer.
- After securing the filament and guide tubes, thread the filament through the guide tubes.

Filament Guide  
Tube Buckle

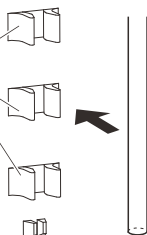

4. Lock the filament guide tube with R-shape buckles.

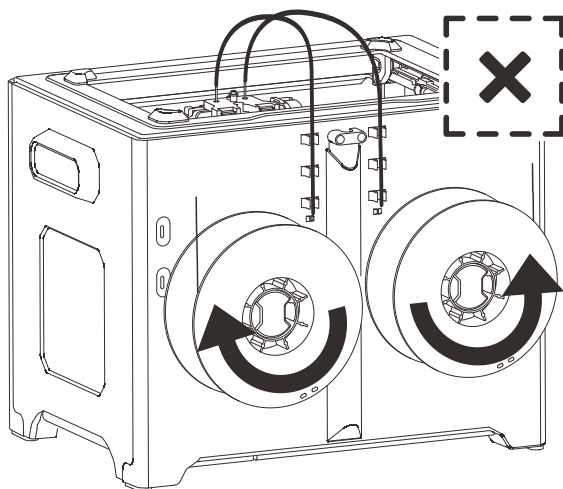
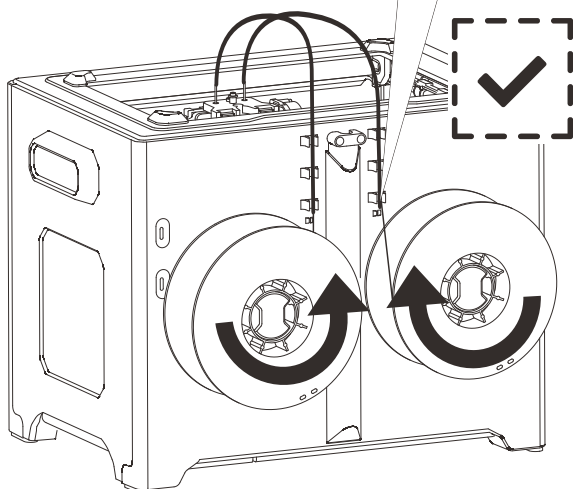

## Leveling Build Platform

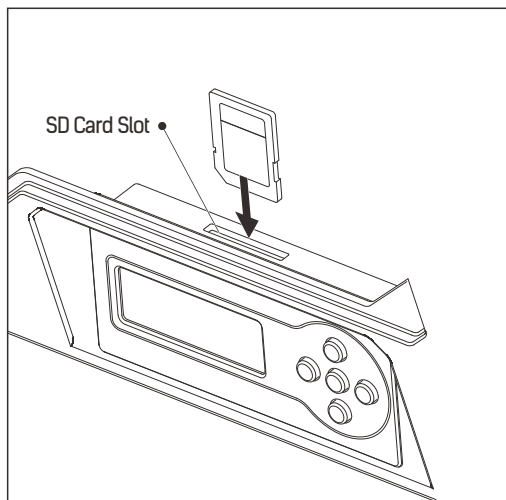

FF Creator Pro  
→ Print from SD  
Preheat  
Utilities

→ ▶ ENG  
▶ FlashPrint GoΣ  
▶ Happy3DΣ soft  
▶

↶  
→ PlateLeveling.x3g  
▶ test model  
Exit Menu

1. Attach the power supply, plug the power cable into an electrical outlet and turn on the printer.
2. Insert the SD card into the slot. Tap [Print from SD] and Tap [OK]. Tap [ENG] and tap [OK].

Then you will see the [Plateleveling.x3g].

### How to use the leveling knobs

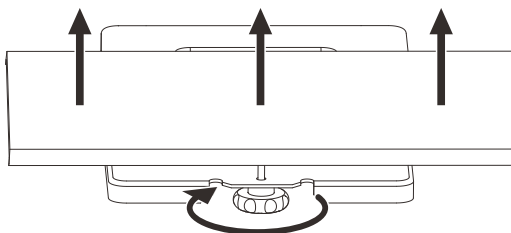

**Rotate knob clockwise**

Raise the build plate to reduce the distance between the nozzle and build plate.

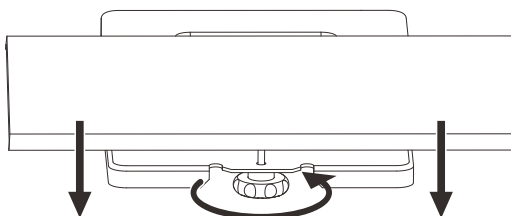

**Rotate knob anticlockwise**

Lower the build plate to increase the distance between the nozzle and build plate.

## How to level the build plate

1. Tighten the three leveling nuts under the build platform until you cannot tighten them any more.
2. Select the PlateLeveling.x3g on the control panel, and tap [OK] to start leveling.  
Then tap [OK] for page-turning to read the leveling instructions.
3. The build plate and nozzle will start to move. Wait for them to stop, then adjust the corresponding knob under the right nozzle first using the leveling card.
4. The leveling card should slide between the nozzle and build plate with some friction/resistance.  
If the card slides through easily, the nozzle and build plate are too far apart. Rotate the knob clockwise to decrease the distance between them. If the card cannot slide through, rotate the knob anticlockwise.
5. After leveling the first point, tap [OK] to continue to the next point.
6. Adjust all three knobs as outlined above. Then, check that the nozzle is also correctly placed when it is at the center of the build plate, using the leveling card. That's it!

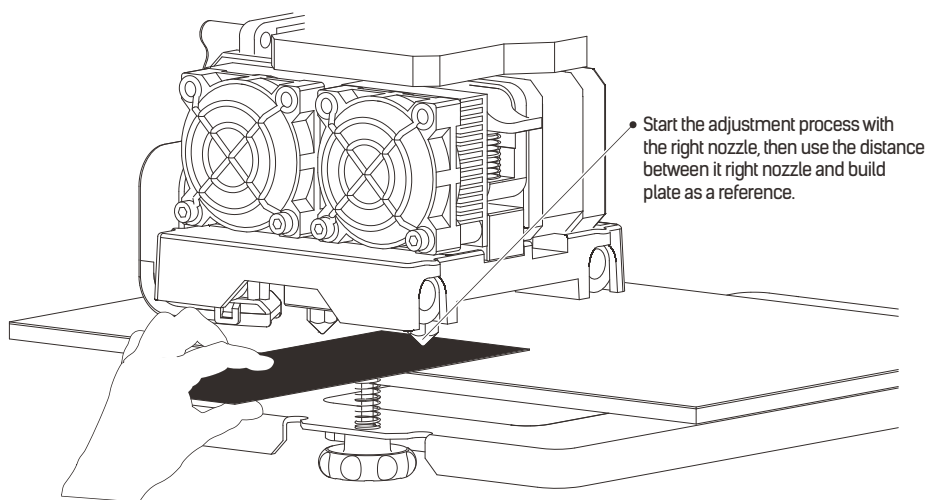

## Loading Filament

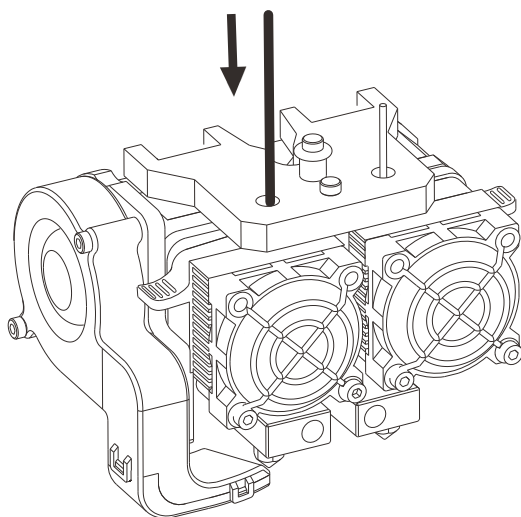

FF Creator Pro

Print from SD

Preheat

→ Utilities

Monitor Mode

→ Filament Loading

Preheat Settings

General Settings

Unload right

Load right

Unload left

→ Load left

Heating: ■■■

R Extruder: 28C

L Extruder: 28/200C

Platform: 21/ 50C

1. Tap [Utilities] and tap [OK]. Tap [Filament Loading]--[OK] to enter the filament loading/unloading page.
2. Tap [Load Left]--[OK].
3. The extruder will be heated up automatically. Once heated, insert the filament through the filament guide tube into the filament intake. Then the filament will be drawn through the extruder.
4. Continue extruding until the extruder provides a steady flow of filament.
5. Tap [OK] to complete filament loading and return to the home page.

## First Print

FF Creator Pro

→ Print from SD

Preheat

Utilities

1

→ ENG

▶ FlashPrint ▶ GoΣ

▶ Happy3DΣ soft

▶

2

↶  
PlateLeveling.x3g

→ ▶ test model

Exit Menu

3

↶ ..  
CP ABS 40mm\_box.Rig

→ CP PLA 40mm\_box.Lef

Exit Menu

4

Heating: ■■

R Extruder: 28C

L Extruder: 28/200C

Platform: 21/ 50C

5

1. Tap [Print from SD]--[ENG]--[test model] successively.
2. Select CP PLA 40mm\_box.Left.x3g file to print.  
(Note: Use the left extruder to print CP PLA 40mm\_box.Left.x3g.  
Use the right extruder to print CP ABS 40mm\_box.Right.x3g.)
3. After selecting the file, tap [OK] and wait for the extruder to heat. Once heated, the printer will start printing automatically.



You **Tube**

Scan QR to Get More  
After-Sales Support



浙江闪铸三维科技有限公司  
**FLASHFORGE CORPORATION**

---

After-Sales Service: [support@ff3dp.com](mailto:support@ff3dp.com)

---

Amazon.com orders only: [597891915@qq.com](mailto:597891915@qq.com)

---

Tel: +86 579 82273989 Web: [www.flashforge.com](http://www.flashforge.com) Add: 2/F, No.518, Xianyuan Road, Jinhua, Zhejiang, China